

# PLYGOOD® Ultra Sheathing INSTALLATION GUIDELINES

PLYGOOD Ultra can be installed vertically on exterior walls and horizontally across gable end walls using the following installation steps:

## Exterior Walls—Sheathing Installed Vertically

1. Start at one end of the home and begin by aligning the bottom edge of the PLYGOOD Ultra sheet with the bottom edge of the sill plate, while also making sure that the vertical edge of the sheet is aligned with the corner stud.
2. Attach PLYGOOD Ultra using staples (1" x 1 1/4" x 16 Ga. or 7/16" x 1 1/2" x 16 Ga.) or 1 1/4" plastic cap nails (spaced 12" o. c.), starting at the bottom edge of the wall. Staples should be spaced 4-5 inches apart for 1" crown staples and 3 inches apart for 7/16" crown staples. PLYGOOD Ultra is printed with staple lines that are intended to guide the installer in locating studs.
3. Continue installing subsequent courses of PLYGOOD Ultra by butting vertical edges of adjacent sheets together and fastening as described in Step 2.
4. Cut door and window openings and other necessary penetration areas using a common utility knife, taking care to inform others that there will be cutting in the area.
5. If fractures occur in PLYGOOD Ultra, they should be taped to minimize the possibility of air infiltration.\*
6. Install the siding and trim accessories in accordance with the manufacturer's installation instructions.

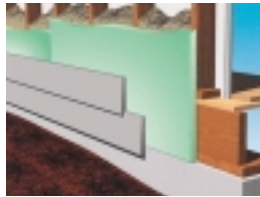

## Exterior Walls—Sheathing Installed Horizontally At The Attic Gable End Walls

1. Begin by taking measurements of the area to be covered with PLYGOOD Ultra and cut the sheets to the correct dimensions. A chalk line can be used to achieve a straight edge cut.
2. Align PLYGOOD Ultra horizontally so that the edge is butted up against the top edges of the vertically installed sheets of PLYGOOD Ultra on the exterior wall.
3. Attach PLYGOOD Ultra using staples (1" x 1 1/4" x 16 Ga. or 7/16" x 1 1/2" x 16 Ga.) or 1 1/4" plastic cap nails (spaced 12" o. c.), starting at the bottom edge of the wall. Staples should be spaced 4-5 inches apart for 1" crown staples and 3 inches apart for 7/16" crown staples. PLYGOOD Ultra is printed with staple lines that are intended to guide the installer in locating studs.
4. If fractures occur in PLYGOOD Ultra, they should be taped to minimize the possibility of air infiltration.\*
5. Install the siding and trim accessories in accordance with the manufacturer's installation instructions.

\*Contact Pactiv Building Products for information regarding approved tape products.

**Compliance**—PLYGOOD Ultra complies with all relevant building codes. For the most current compliance information, go to [green-guard.com](http://green-guard.com).

## GreenGuard® Disclaimers

- **WARNING:** Foam plastic insulation will ignite if exposed to fire of sufficient heat and intensity. Protect foam insulation from exposure to open flame or other ignition sources during shipping, storage, and installation.
- These products should not be used as an exposed interior surface in buildings where people can be expected to be present. An approved fire protection barrier, such as 1/2" gypsum wallboard or the equivalent, should be applied between these products and the interior of such buildings. Fire and building codes should be followed.
- All assemblies should be evaluated for effectiveness and location of vapor retarders to avoid condensation and subsequent damage to structures (ASHRAE Handbook of Fundamentals).
- Since foam sheathings are non-structural, they must be installed over adequately braced framing in accordance with local building codes.
- GreenGuard PLYGOOD Ultra was evaluated for compliance with the new International Code Council-Evaluation Services (ICC-ES) interim "Acceptance Criteria For Foam Plastic Sheathing Panels Used as Weather-resistive Barriers" (AC71). GreenGuard PLYGOOD Ultra having a minimum nominal thickness of 3/8", performed favorably when subjected to the requirements described in AC71. Compliance with AC71 means that GreenGuard PLYGOOD Ultra may be used in either new or retrofit construction applications without an additional weather-resistive barrier (felt building paper or housewrap) when installed in strict accordance with the installation instructions for using PLYGOOD Ultra as a weather-resistive barrier. Contact Pactiv for more information.
- For more information on specific building product recommendations and installation guidelines, contact your Pactiv Building Products insulation representative.
- Pactiv Building Products believes the information and recommendations herein to be accurate and reliable. However, since use conditions are not within its control, Pactiv Building Products does not guarantee results from use of such products or other information herein and disclaims all liability from any resulting damage or loss. NO WARRANTY, EXPRESS OR IMPLIED, IS GIVEN AS TO THE MERCHANTABILITY, FITNESS FOR PARTICULAR PURPOSE, OR OTHERWISE WITH RESPECT TO THE PRODUCTS REFERRED TO.

US Patent No. 6,536,176

GreenGuard and PLYGOOD are registered trademarks of Pactiv Building Products.  
© 2004 Pactiv Building Products, 10/04.  
INSTL-PGU-SHT